



# Town Hall Meeting

Visitation Master Plan | 05.24.2022

# YOUR VISITATION CATHOLIC SCHOOL TEAM

---



**Keegan Jackson**  
Senior Partner



**Sandy Cochran**  
Client Leader



**Nicole Rezai**  
Interiors



**Kelsey Miller**  
Architecture



**Matt Evett**  
Landscape Architect

**100+**

Master Plans

**36**

Years of Catholic  
Partnerships

**100+**

Staff Resources



## Agenda

- Master Planning Schedule
- Assessment Review
- Planning Criteria & Priorities
- Opportunities
- Feedback Exercises – Comment Card
- Next Steps







**CO**  
create

Design  
Experts

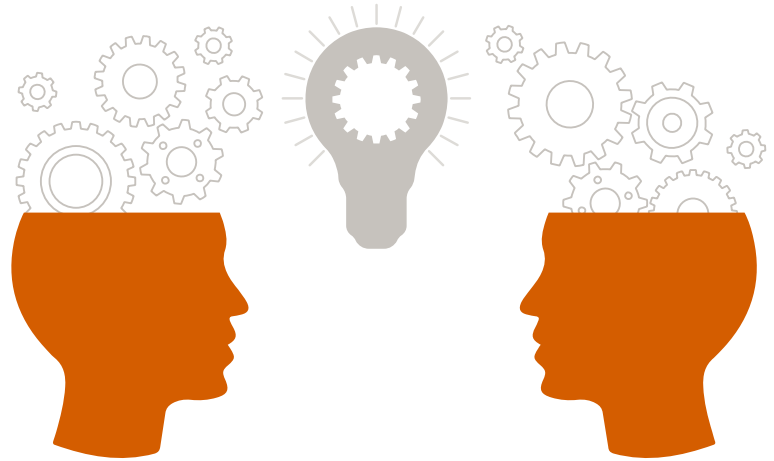

Education  
Experts

Leveraging expertise through  
strong relationships.

Visitation  
A CATHOLIC COMMUNITY





**Step 1**  
Game Plan



**Step 2**  
Collect Data



**Step 3**  
Planning Criteria



**Step 4**  
Explore Options



**Step 5**  
Adopt the  
Best Plan



**Visitation**  
A CATHOLIC COMMUNITY

# Our Approach

# PLANNING PROCESS & SCHEDULE



1



## GAME PLAN

Co-create a game plan

- Clarify expectations & goals.
- Identify Leadership Vision Team
- Confirm schedule.
- Establish engagement strategy.
- Identify roles and communication lines.
- Review and approve proposal.

Game Planning Meetings  
Steering Committee  
Building Committee  
Leaders & Special Interests

2



## DATA COLLECTION

Step 2 Kick Off Meeting

- Educational Vision
- Curriculum Discovery and Vision Discussion
  - Learning & Precedent Tour
  - Learning Belief Exploration

Parish Wide Community Engagement  
Community Perception Survey

Facility/Site Assessment Interview + Tours

Facility Assessment Needs Matrix Priorities

3



## PLANNING CRITERIA

Step 3 Kick Off Meeting

- Planning Criteria Creation
- Space Program Creation
- Review Criteria + Program

4



## EXPLORE OPTIONS

Step 4 Kick Off Meeting

- Explore Multiple Option
- Explore Scopes & Options
  - Review & Input
  - Refine Scope & Options
  - Project Cost Development

Leaders & Special Interest Engagement  
• Share outcomes & progress

Parish Wide Engagement Town Hall  
• Share outcomes & progress

5



## ADOPT BEST PLAN

Step 5 Kick Off Meeting

- Refine Master Plan Option
- Refine Scope & Options
  - Facility Needs Matrix Integration
  - Review & Input
  - Refine Scope & Options
  - Total Project Cost Refinement

Update & Review Progress

Deliverables – Create digital booklet

Parish Wide Engagement

Plant the seed for next steps – campaign

Oct 26 – Nov 14

Nov 15 – Dec 14

Jan 18 – Mar 30

Mar 31 – June 3

June 6 – June 30



- Sense of Community
- Flexible Campus
- Outside Forces (The Neighborhood)



MAIN STREET STREETScape VISION PLAN

CONFLUENCE

## Our Understanding

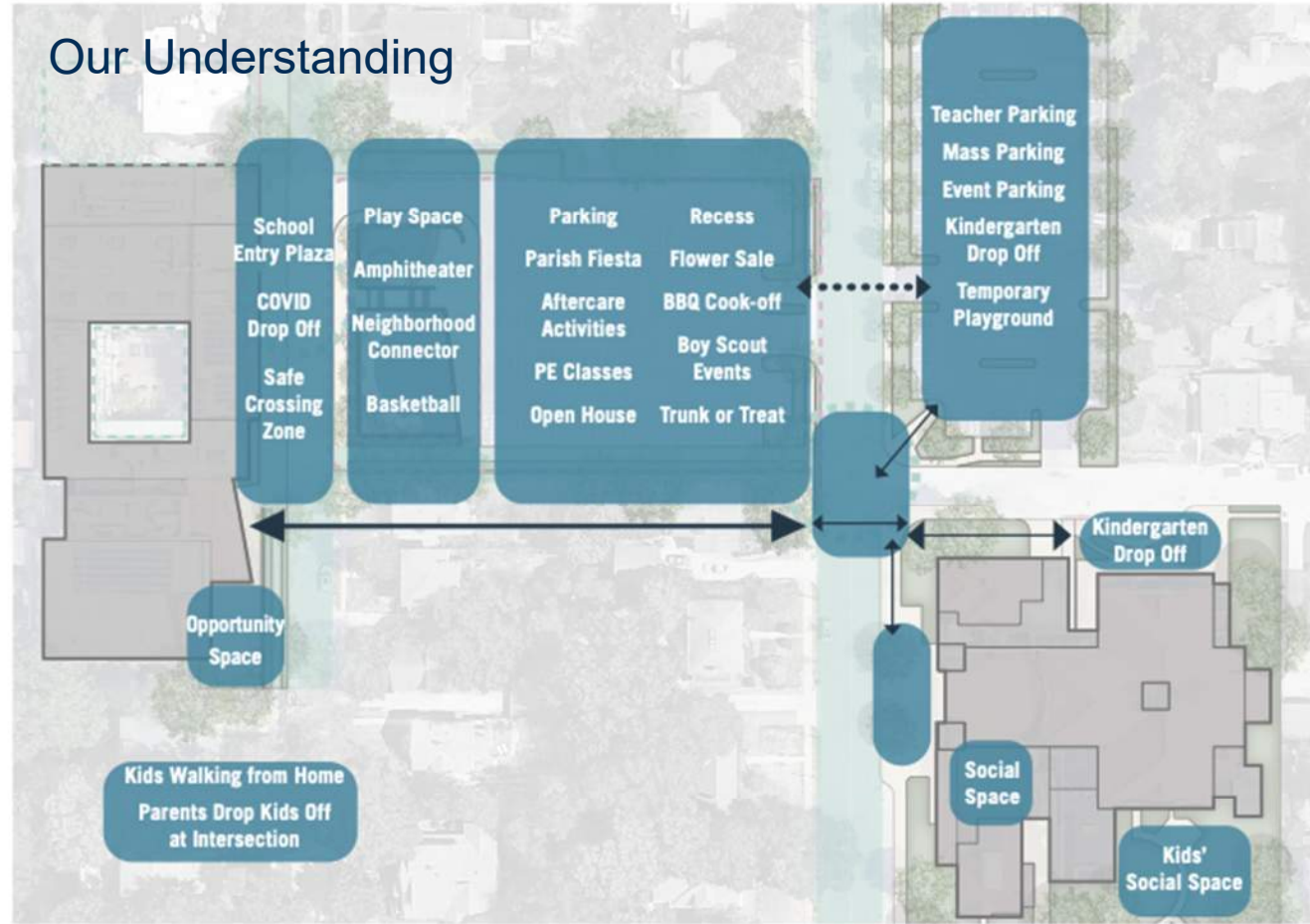

# Existing Building Assessments





## Interior Upgrades

---

- Cafeteria Renovation Kitchen & Serving
- Classroom Collaboration Spaces/Break out Spaces
- Media Center/Library Upgrades for added use
- Additional Storage – All Areas
- Interior Finish Renovations – Throughout
  - Ceiling & Wall Finishes, Flooring, Casework
  - Lighting Upgrades to LED
- Restroom Renovations
  - Plumbing Fixtures, Partitions, Lighting, Finishes
- VCT Flooring Repairs
  - Concrete Cracking
- Window Blinds for Sunlight Control
- Finishes & Lighting in Stairwells



- Sound Isolation and Acoustics in Music Room
- Door Hardware Consistency & Keying
- Replace transom panels over classroom doors
  - Mixed glass and perforated

# School Building

# Interior Upgrades

## Mechanical – School Building Interior

- HVAC Control System Upgrade
  - Temperature Control
  - Library Loft Heating and Cooling

## Electrical – School Building Interior

- Elevator Upgrade
- Electrical Outlet Upgrades
  - Additional Classroom
  - Cafeteria to Teacher lounge
- Lighting Upgrades to LED
  - Lighting in Stairwells
- Fire Alarm System Upgrade
- Bell & Timeclock Upgrade
- Security System Upgrade

## Plumbing – School Building Interior

- Building water shutoff valves
- Sewer and Domestic Water Piping Replacement
- Restroom Plumbing Upgrades
  - Toilets, Sinks, Faucets, Valves



School Building Mech, Electric, Plumbing 

## Building Perimeter – School Campus

---

- Window Replacements
- Roof Restoration
- Building Exterior Brick Restoration
- Courtyard Upgrades for Future Use
  - Space revisions
  - Exterior Furniture
  - Sewer line repair/replacement
- Student Access to Church for Mass
  - Perimeter, Sidewalk, and Parking Lot Lighting Upgrades
- Playground & Baltimore Crossing
  - Crosswalk, Signage Upgrades
  - Playground Equipment & Surfacing Upgrades
  - Handrail & Guardrail Restoration
  - Sidewalk Concrete Restoration
  - Rock Wall Restoration
- Ramped entry apron to Gym Garage Door
- Outdoor Play/Parking Area Campus Development
  - Parking for Staff and Visitors



# School Campus Exterior



# Planning Priorities





Top  
Planning  
Priority

Would be  
nice – but  
not a  
“must-  
have”

Save for  
future  
planning  
efforts

Doesn't  
apply to  
Visitation

## Identifying Planning Priorities



# Planning Priorities:

Pathway to success

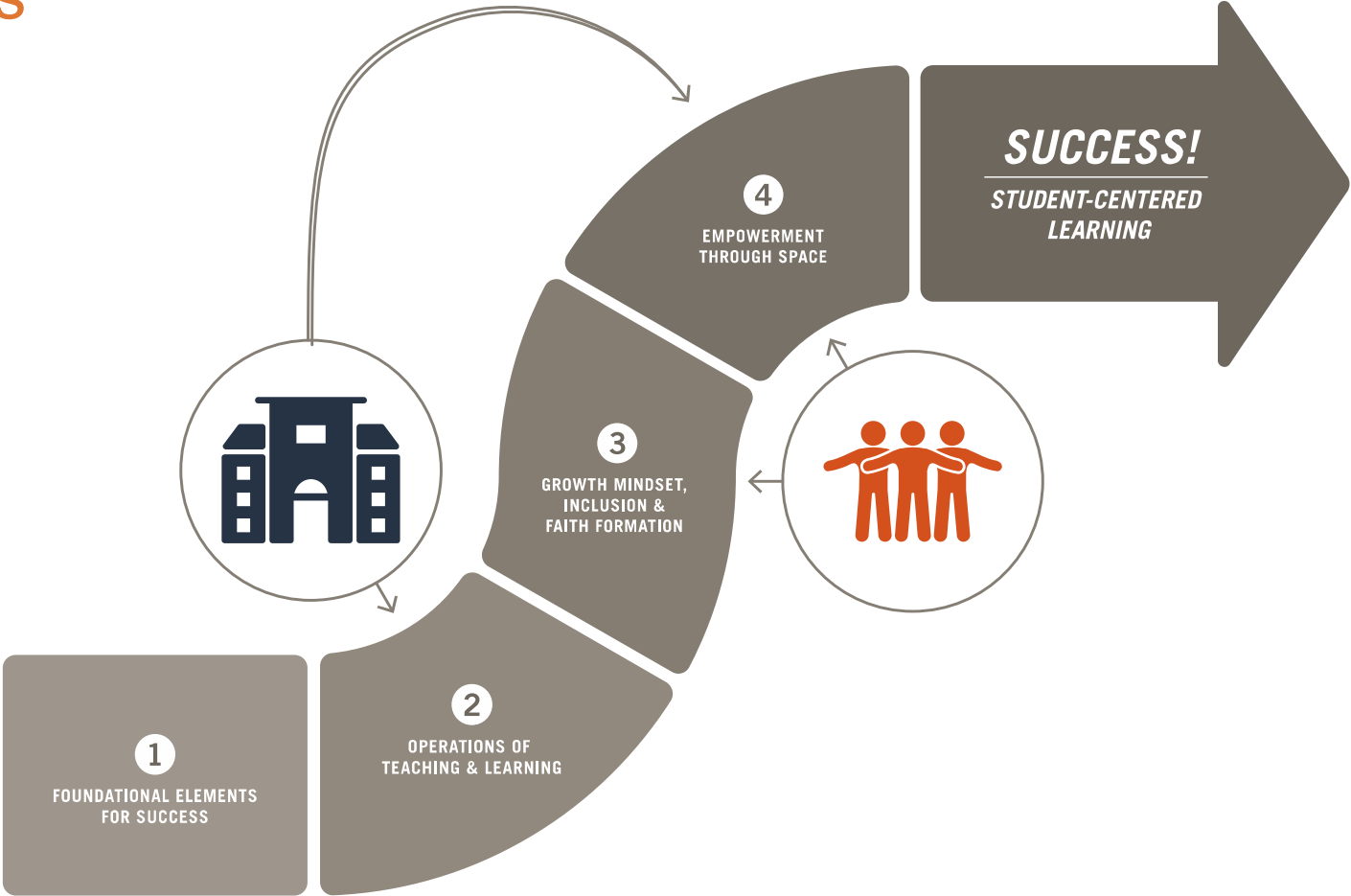

- *Student-centered and inquiry-based learning*
- *Opportunities for new instructional approaches*
- *Variety of learning spaces*

- Learning and play spaces for all
- Student collaboration and resource areas beyond classrooms

- Integrated early childhood opportunities
- Identified student to teacher ratios
- Support for high-quality staff

- Safe and secure facilities and play spaces
- High-quality building infrastructure and systems
- Incorporation of technology as a supportive tool

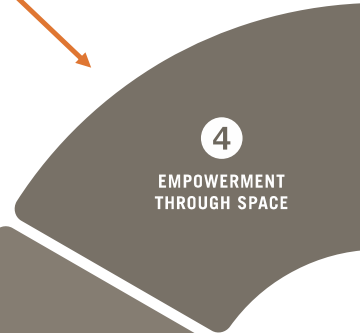

Physical space solutions to support growth in teaching and learning through empowerment of students and staff



## School Staff Results - 33

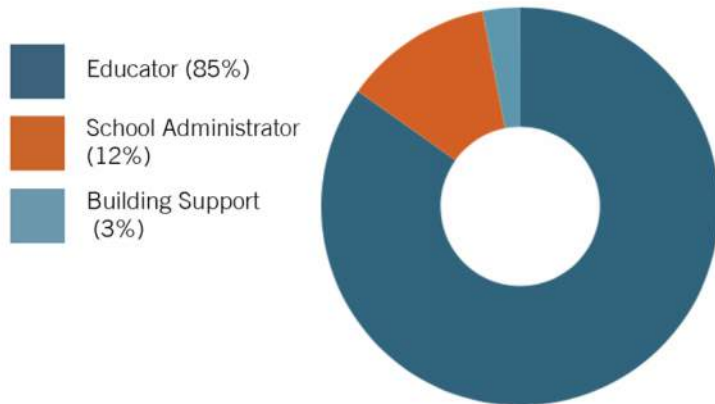

## Parishioner Results - 282

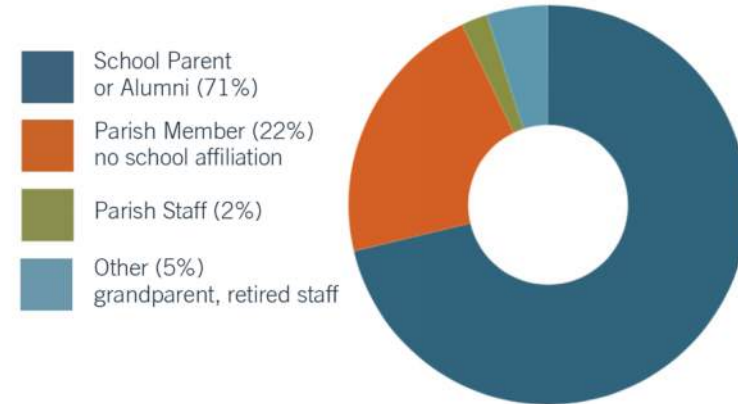

### Common Themes

- Storage & technology
- Safe spaces and protocols are a must
- Implement spaces to support small group work and unique instruction – **Differentiated Learning Spaces**
- Maximize the courtyard space for better learning opportunities
- Great kids come from great adults – focus on staff input & development

### Common Themes

- Exterior & interior safety
- **Teacher recruitment & retention**
- Equity in learning-level approaches (EC, KG, transitions to HS)
- Technology planning
- Future-ready skillsets paired with continued faith-based instruction

# Survey Results





# Visitation School Staff – Research findings

*“The inability to have break out spaces that can support different types of activates simultaneously.”*

*“It is a challenge to set up for labs, I can’t use the cafeteria except on half days because there are lunches in the middle of my class.”*

*“The cabinets are high and require a chair to reach.”*

*“We need to consider how best to provide engaging learning opportunities and spaces to support them. We need to build and plan for flexibility so that we are not locked into a single purpose or use or model. Catholic education has succeeded for many years by being flexible enough to make learning work despite challenges of space and resources.”*



**LEARNING SPACED USED OUTSIDE OF CLASSROOMS**

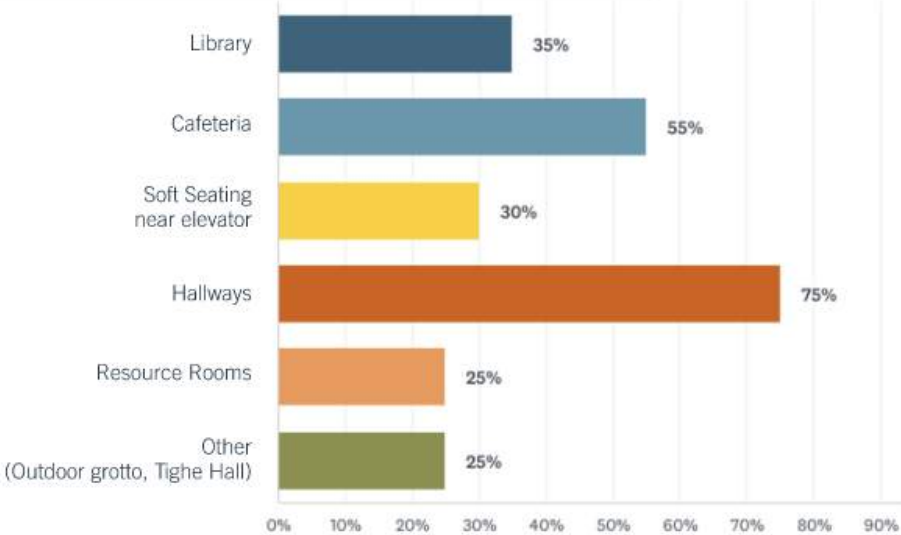



## Mason Elementary

Lee's Summit - Missouri

### General similarities:

Composed of Classroom, Counseling, Support Staff, and Multi-purpose space



## St. Elizabeth's Early Childhood Center

Kansas City - Missouri

### General similarities:

- Catholic Faith Based School
- Addition to K-8 of Early Childhood Center

# Building Tours



# Planning Priority Criteria

---

- Adequate space & room to grow
- Flexibility in spaces
- Appropriate and variation in collaboration spaces
- 6<sup>th</sup> – 8<sup>th</sup> Grade space experience, identity
- Small rooms require rethinking teaching space & storage



# Top Priorities





- Guided Secure Entry
- Playground Access - Baltimore Crossing
- Student Access to Church for Mass
- Building Security & Fire Alarm System Upgrades
- Campus Identification



Student Safety & Security

TOP PRIORITY



- Building Addition to North
  - Additional Classrooms (K-8 or Early Childhood)
  - Additional Storage - All Areas
  - Classroom Collaboration Area/Break out Spaces
- Cafeteria Renovation Kitchen & Serving



Relocation of Kindergarten

**TOP PRIORITY** 

- **Building Addition to North**
  - New space for Early Childhood Program
- **Outdoor Play/Parking Area Campus Development**
  - Parking for Staff and Visitors
  - Playground Equipment and Surfacing Upgrades
- **Campus Perimeter Upgrades**
  - Perimeter, Sidewalk, and Parking Lot Lighting Upgrades
  - Outside Space & Approach Upgrades



Early Childhood Curriculum

TOP PRIORITY 

Opportunities





The Quad





Existing Site Plan







Quad Functional Uses + Activities





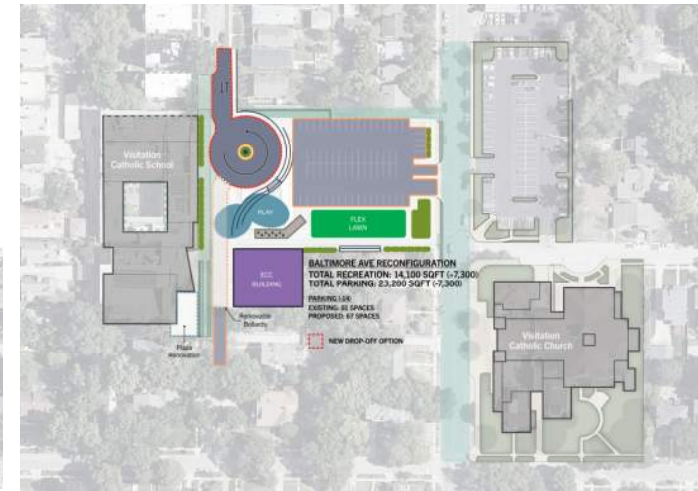
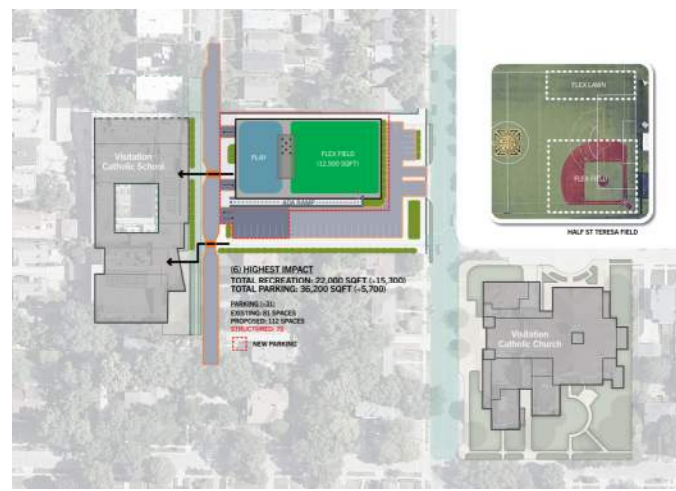
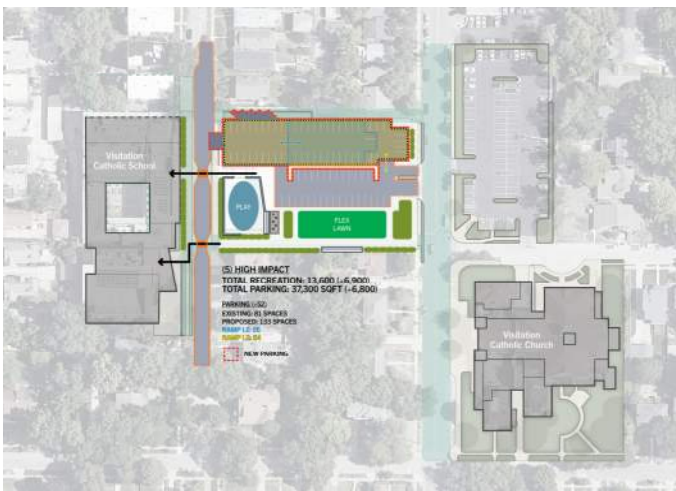
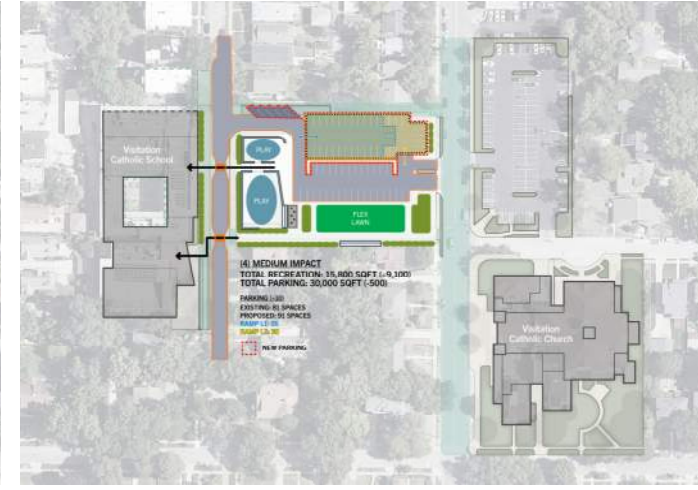
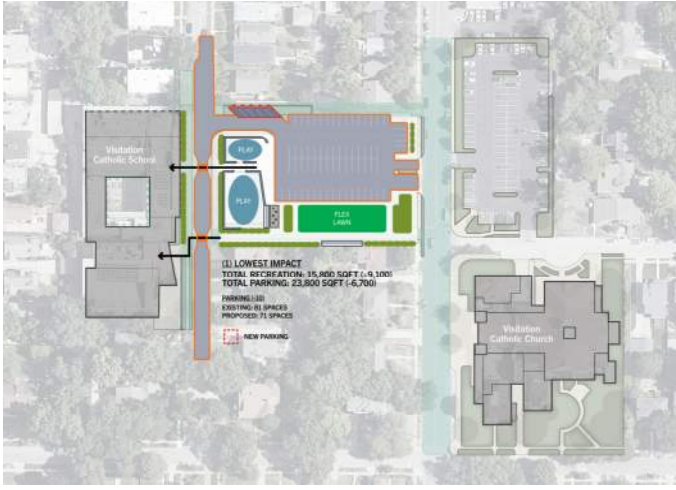

# Configuration Exploration



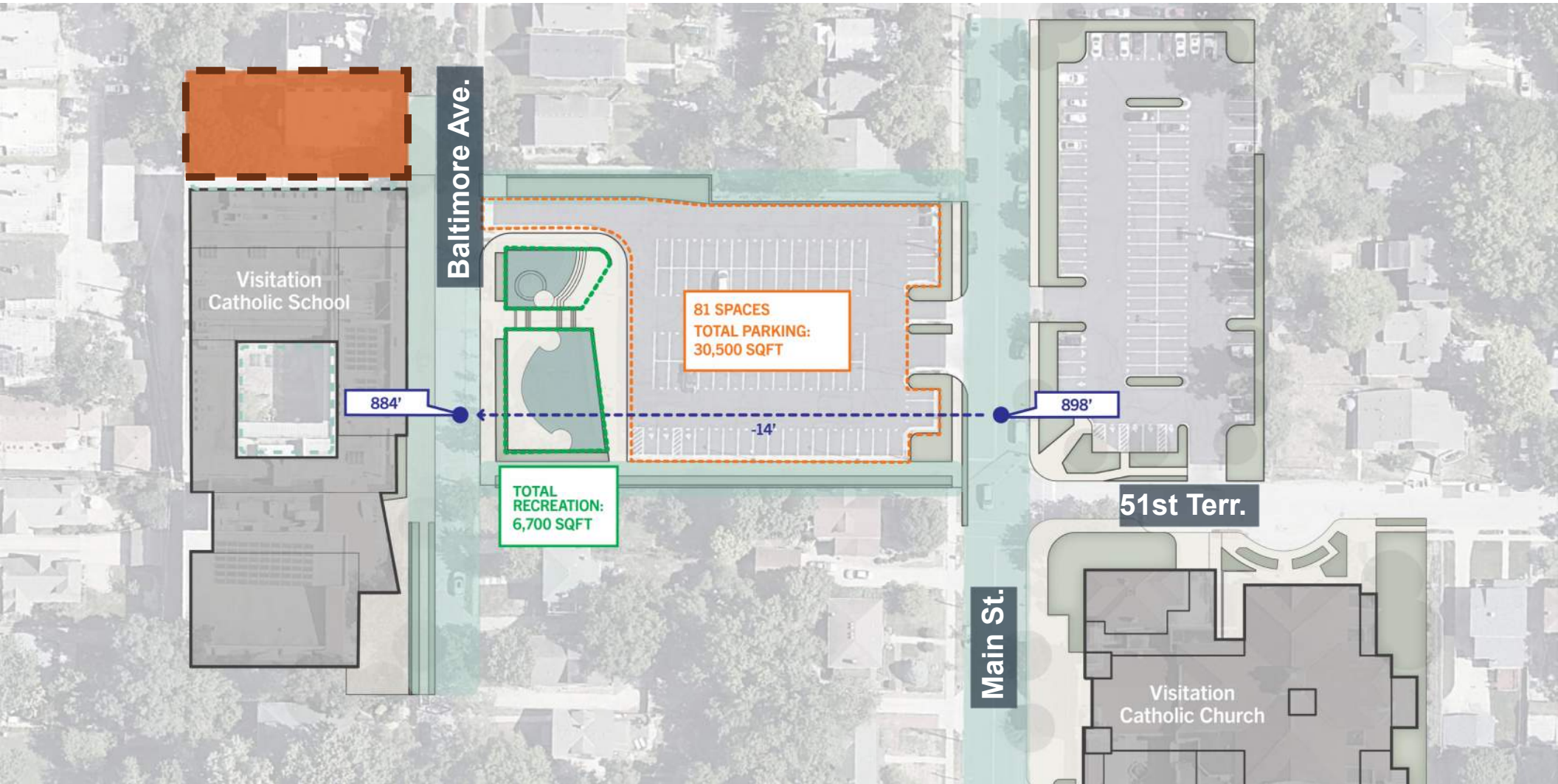

# Existing Conditions







Parking Efficiency





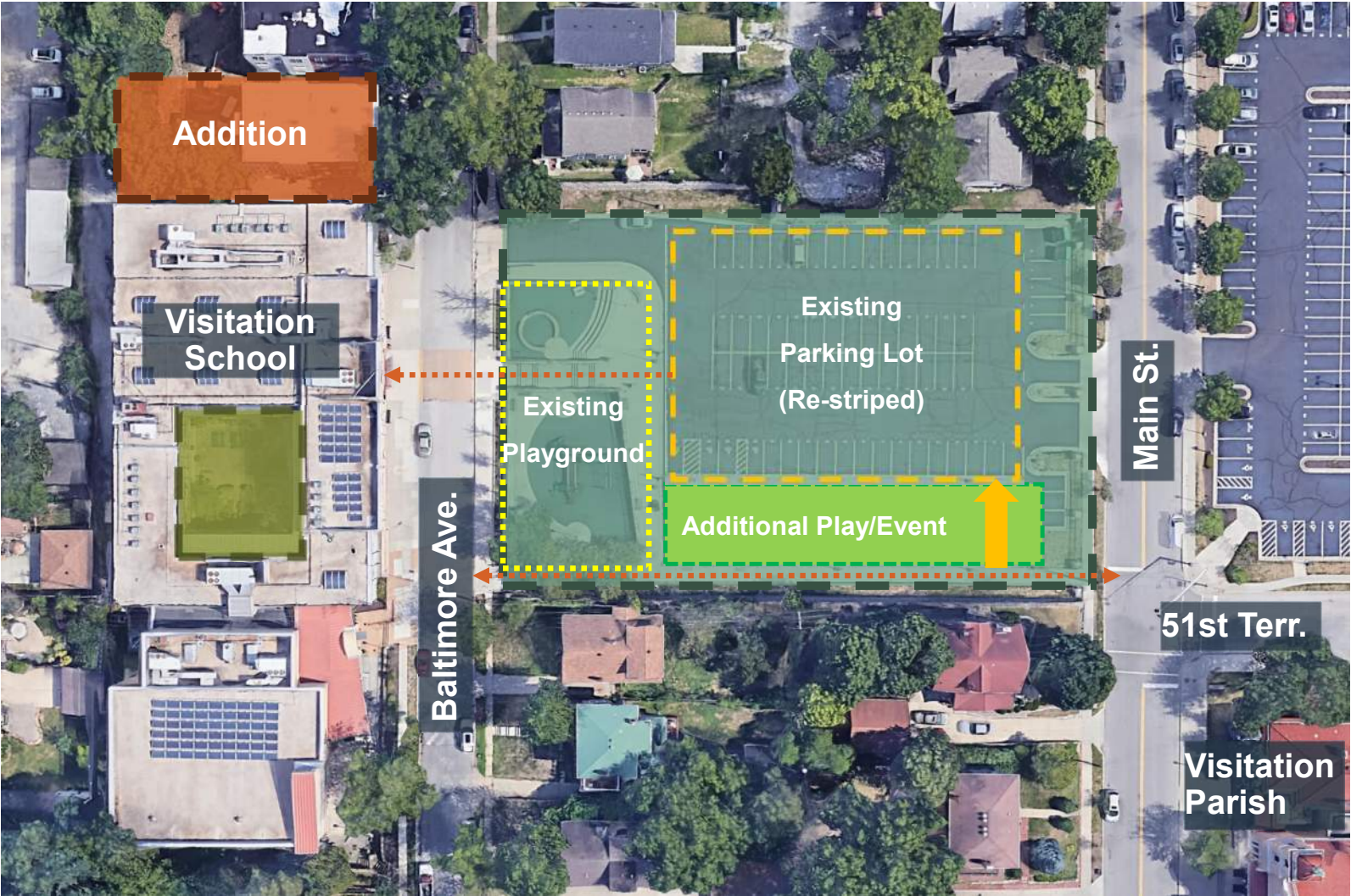

Parking Efficiency – Shift North





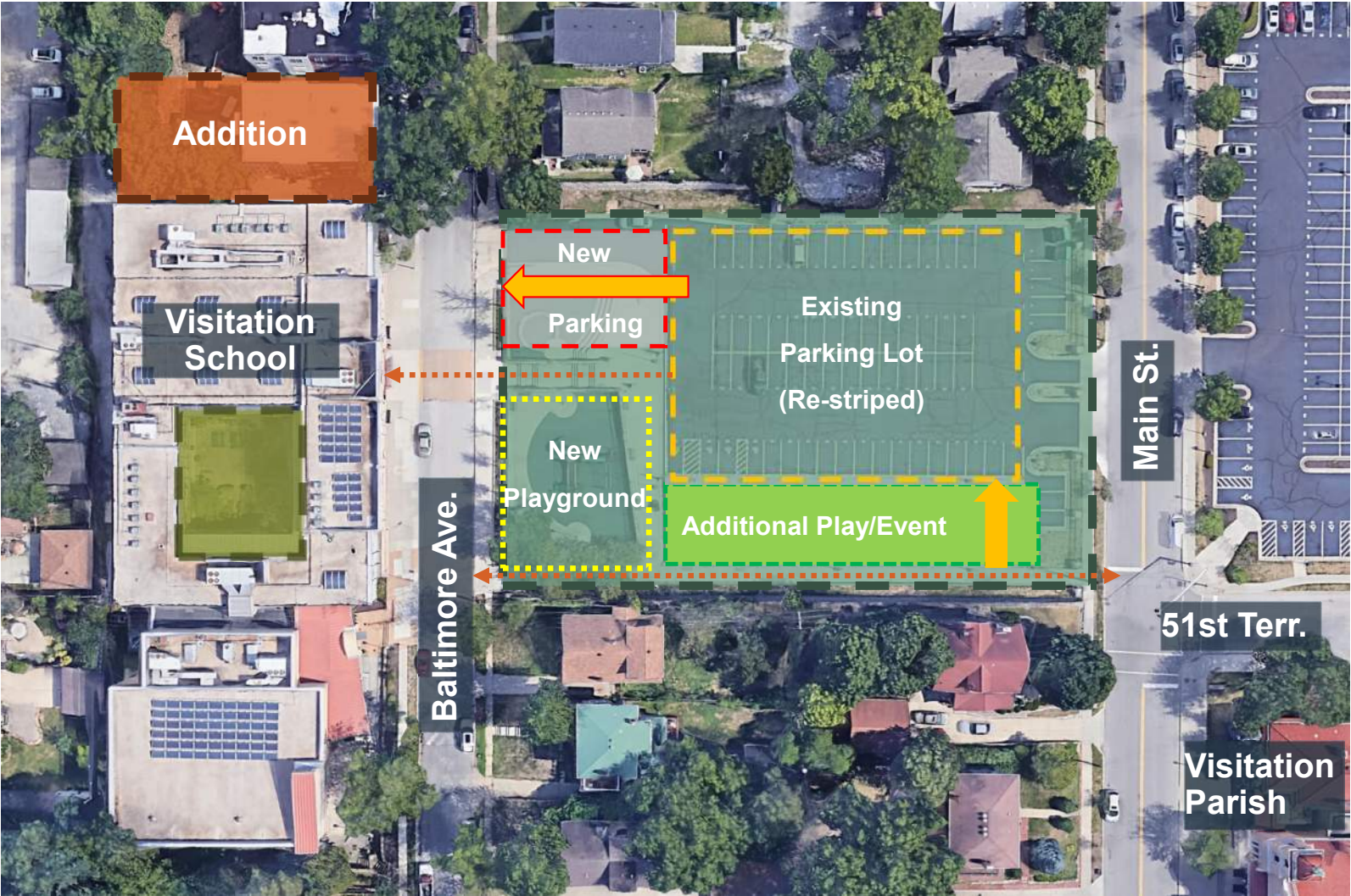

Quad Option 1 (NW Parking Expansion)



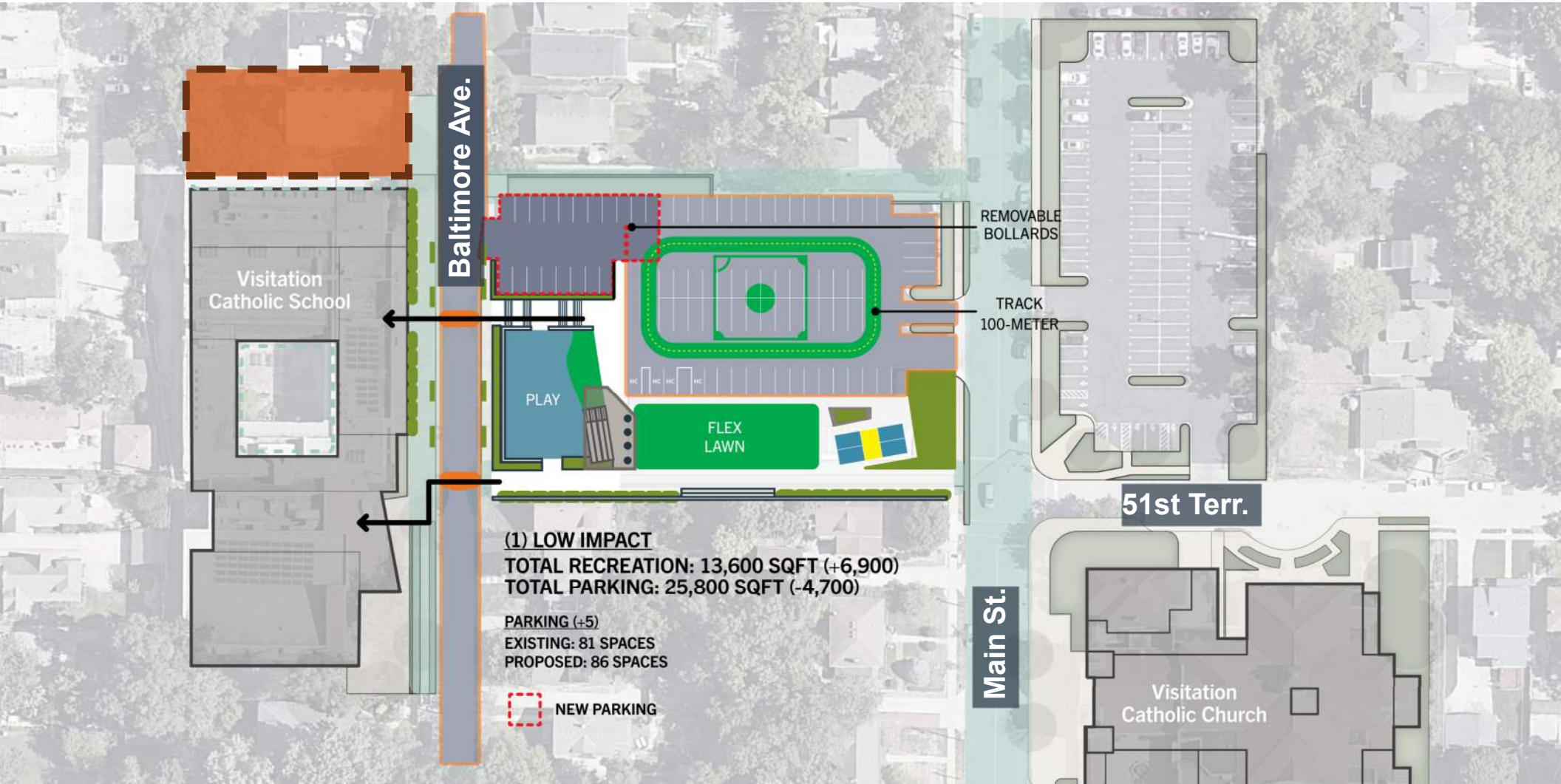

Quad Option 1







Quad Option 1







Quad Option 1





Quad Option 1





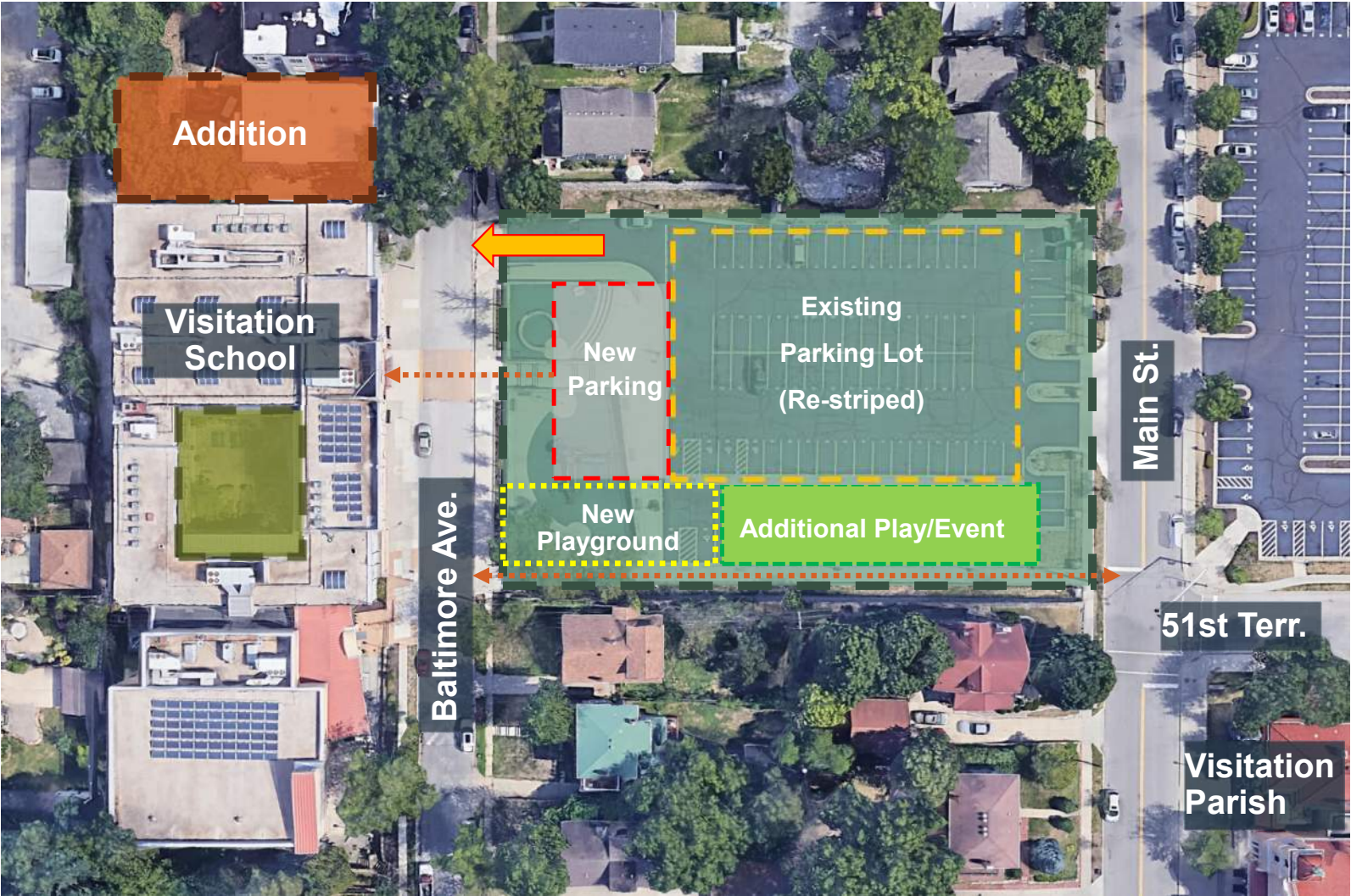

Quad Option 2 (West Parking Expansion)



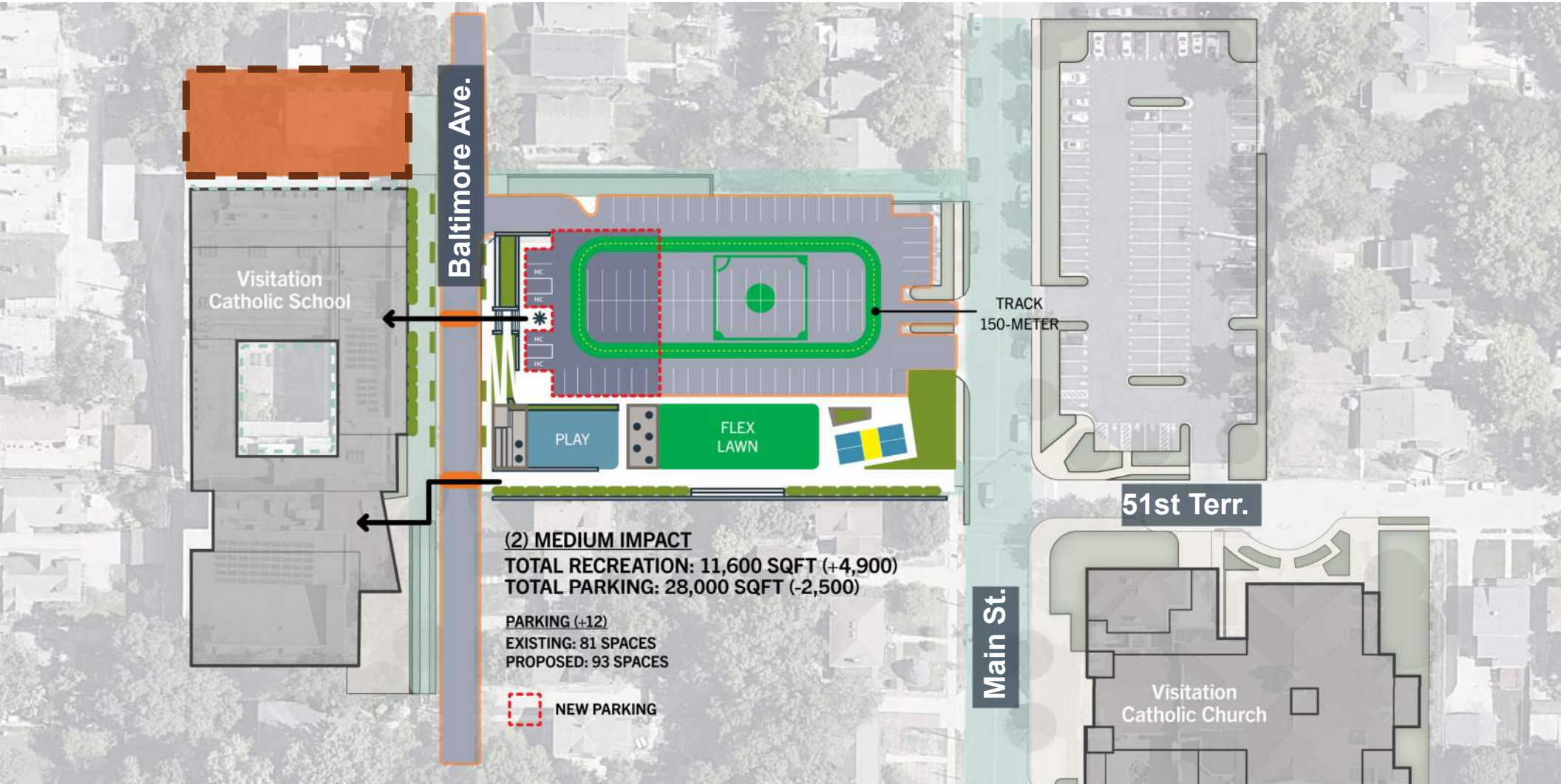

Quad Option 2







Quad Option 2







Quad Option 2







Quad Option 2







# Campus Improvement Considerations

# Faith Courtyard Study







Existing Conditions

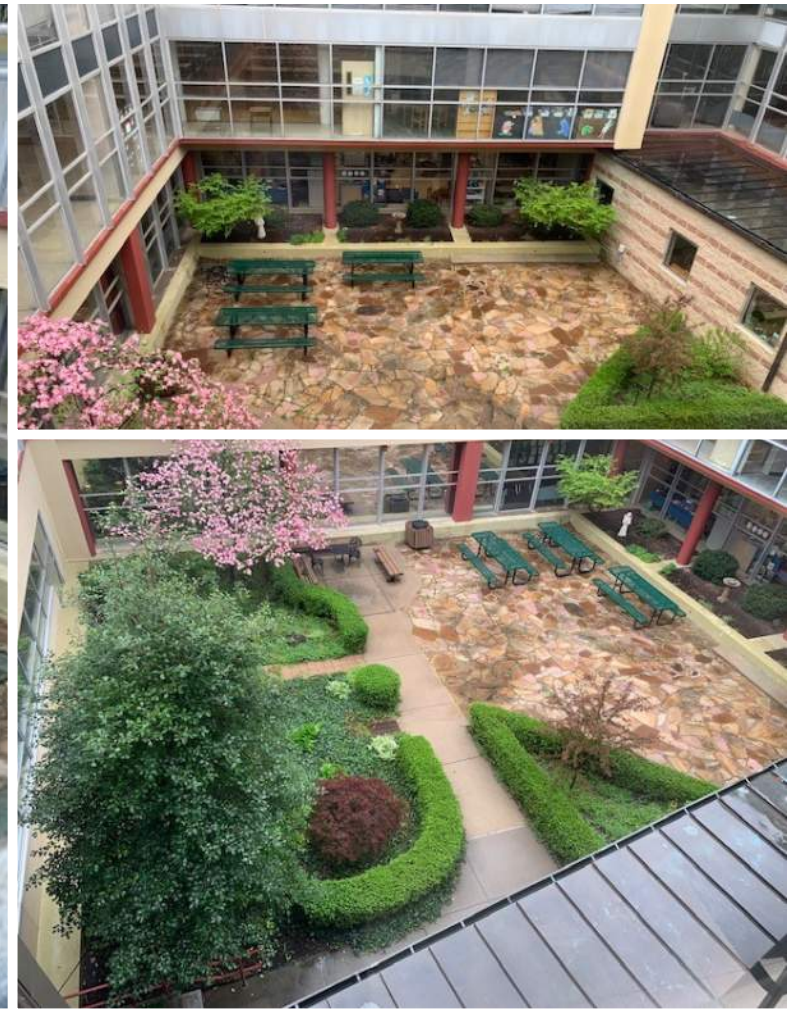

Faith Courtyard





# Courtyard Programming

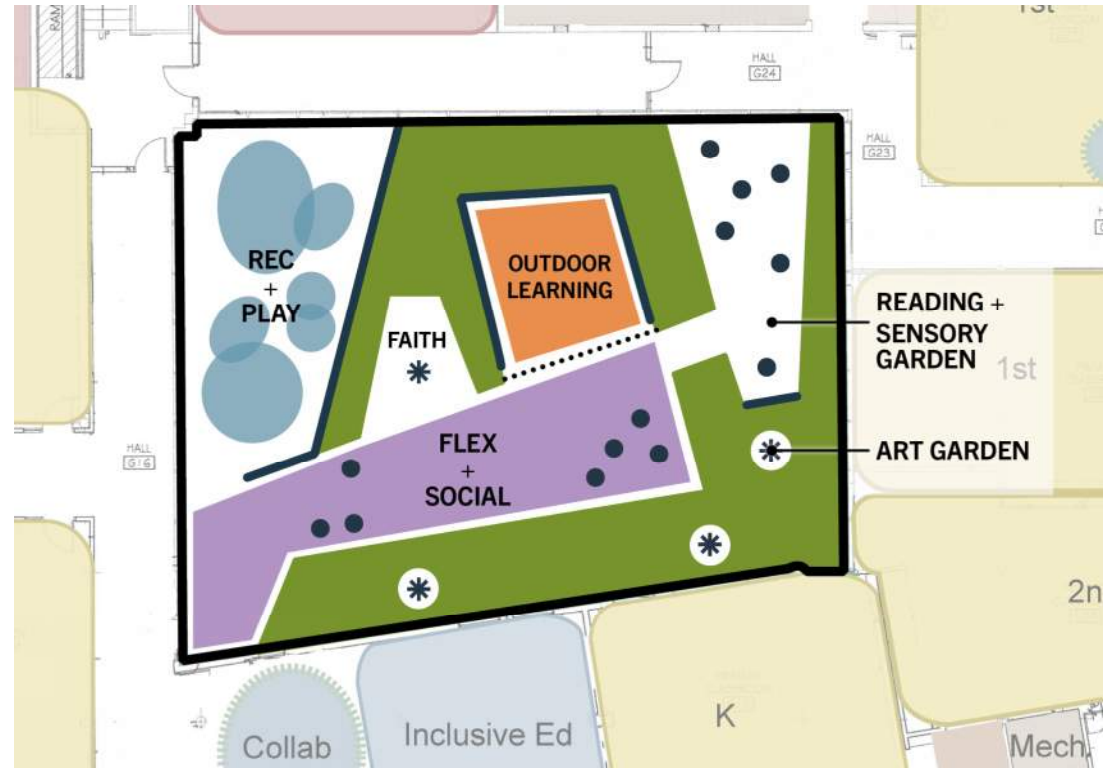

Social Commons

Ground Floor Plan



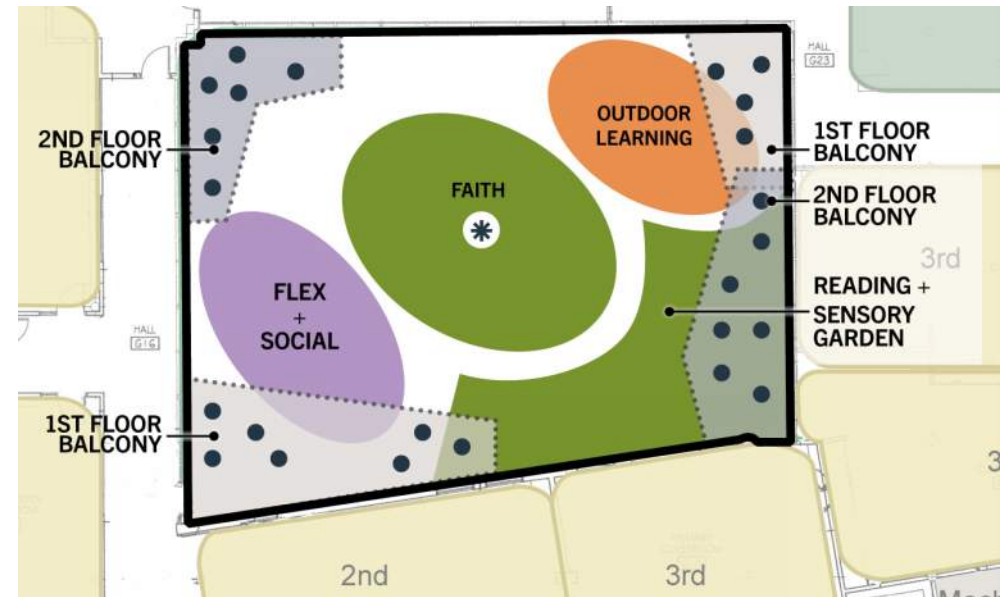

Faith Overlook

Ground Floor Plan



Building



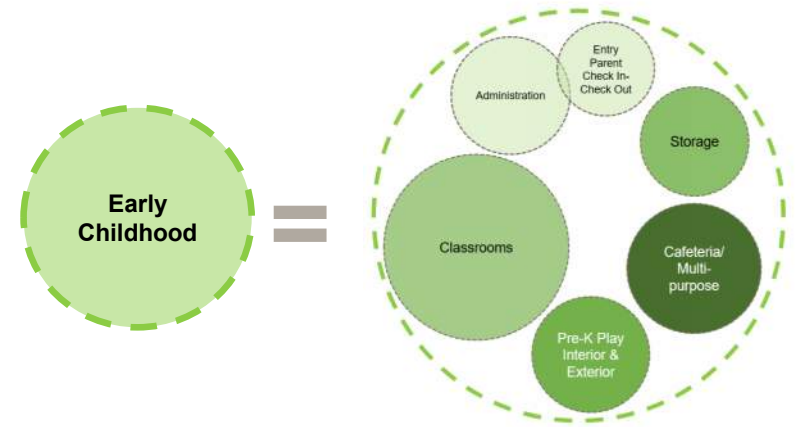
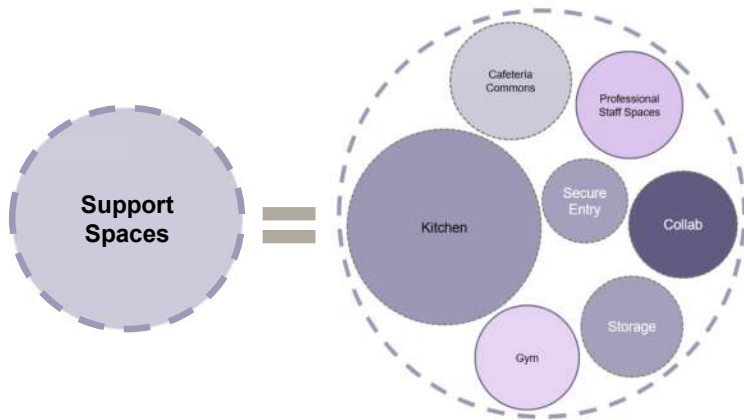
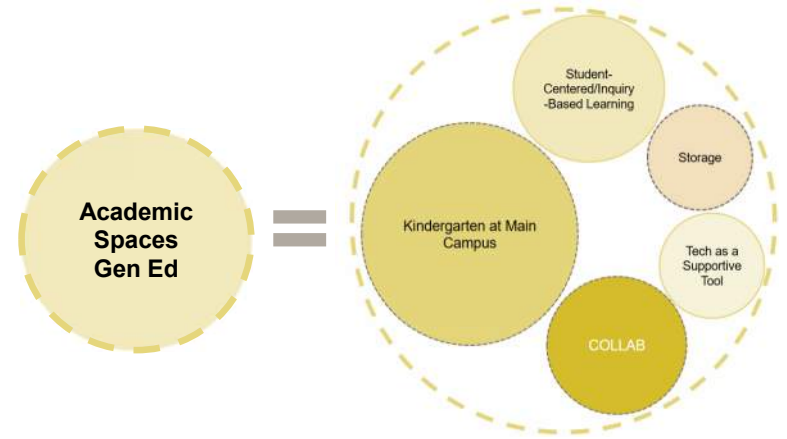
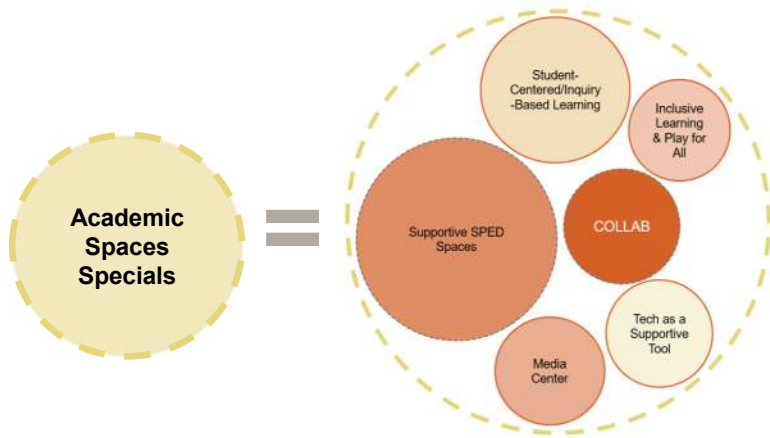

# Space Programming Priority



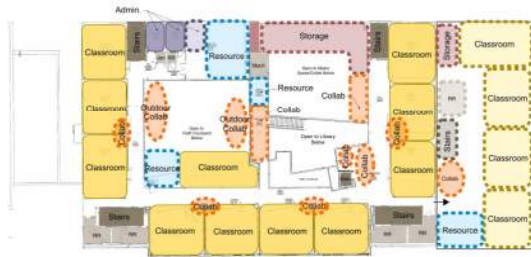

SECOND FLOOR PLAN



SECOND FLOOR PLAN

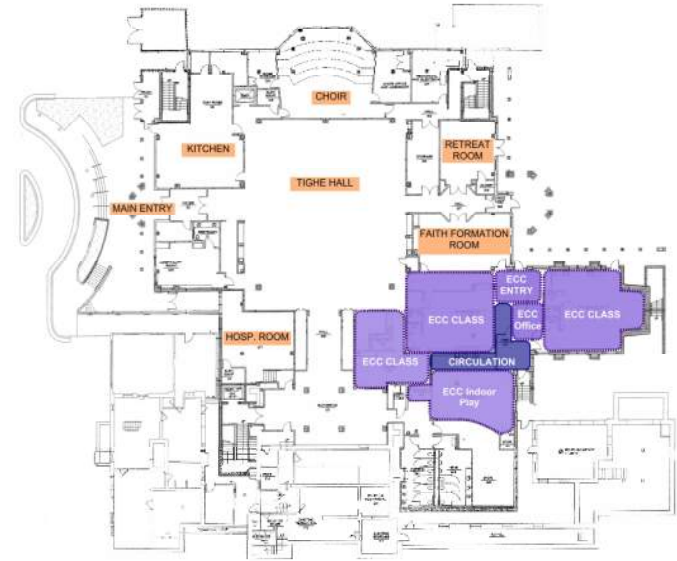

Opportunity - Tighe Hall



FIRST FLOOR PLAN

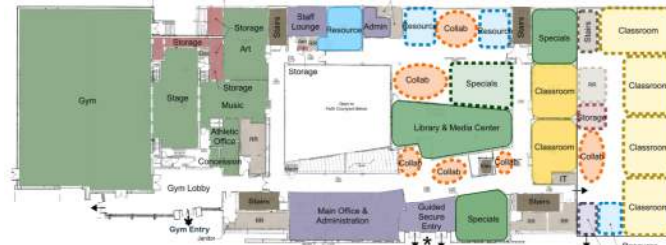

FIRST FLOOR PLAN

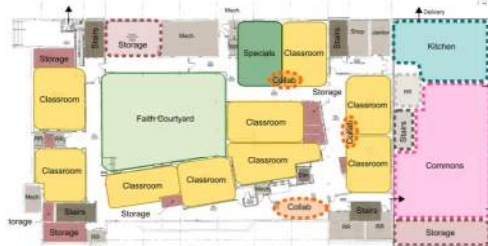

GROUND FLOOR PLAN

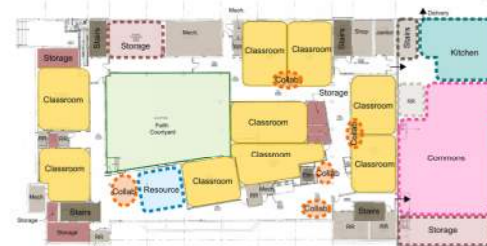

GROUND FLOOR PLAN

Opportunity - Bldg Addition A

Opportunity - Bldg Addition B

# Pending Building Opportunities



# Addition Option 1

- ECC on main level, with separate entry
- ECC Outdoor Play Adjacent to ECC
- Kitchen in Addition
- 6<sup>th</sup>-8<sup>th</sup> space identity
- + 3,029 square foot of Storage

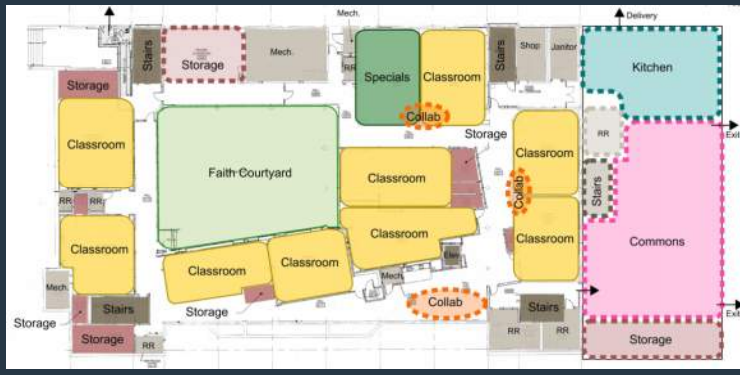
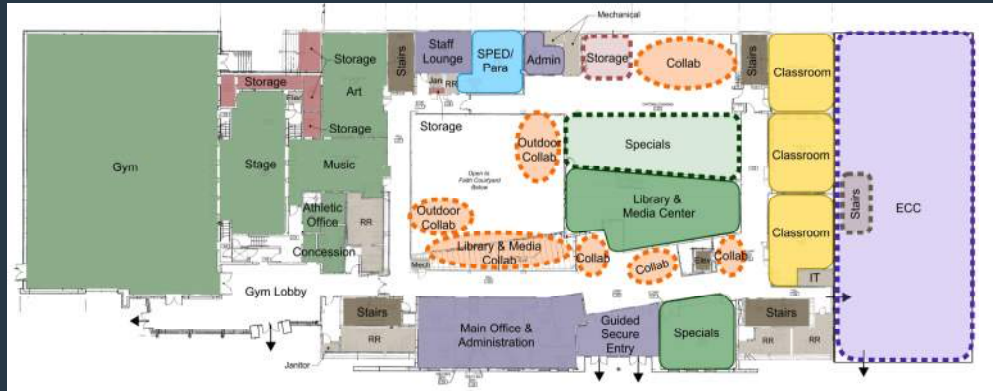
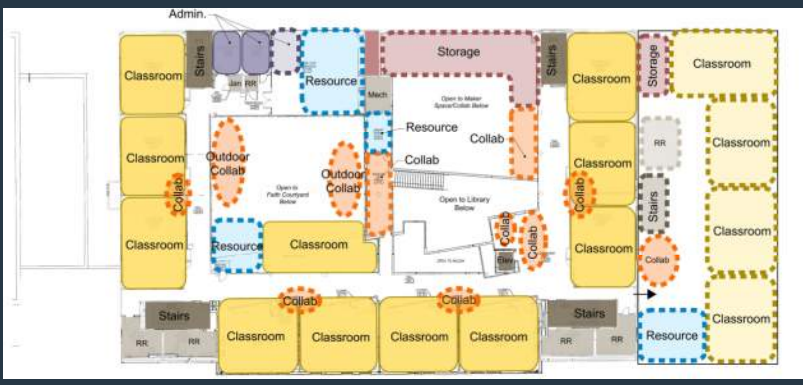

# Addition Option 2

- Kitchen in Addition on lower level with Alley access
- Maximized K-8th without ECC
- 7th-8th Experience Adjacent to Media Hub
- + 2,711 square foot of Storage

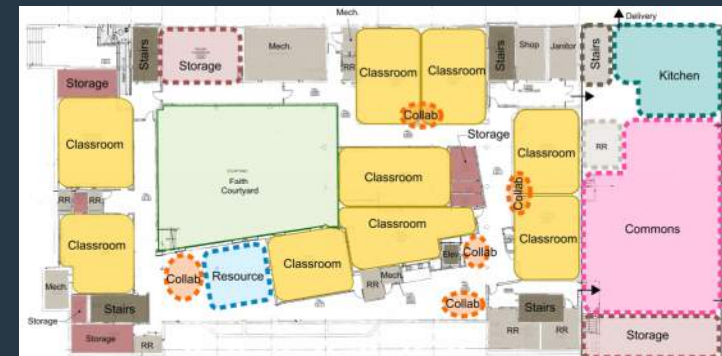
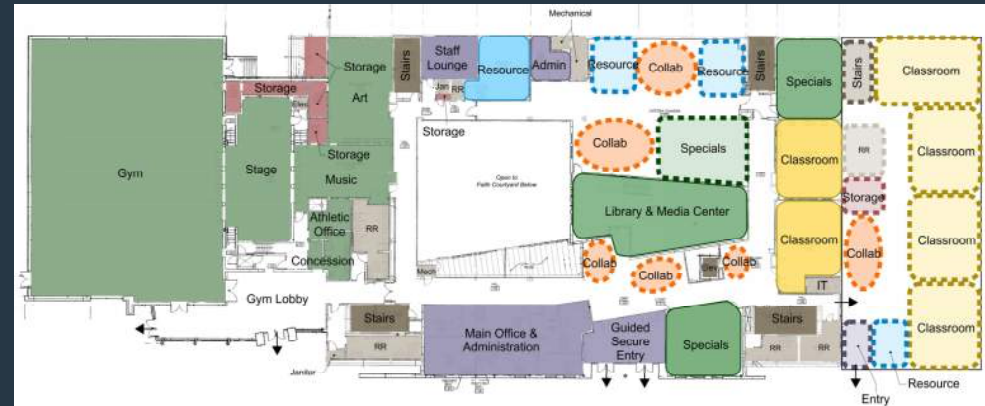
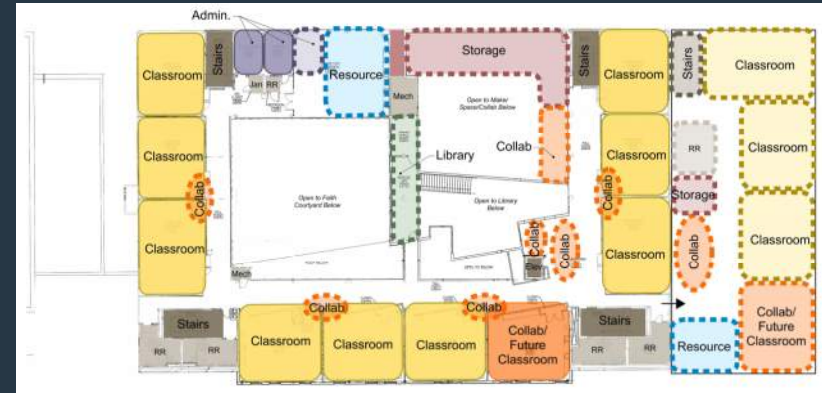

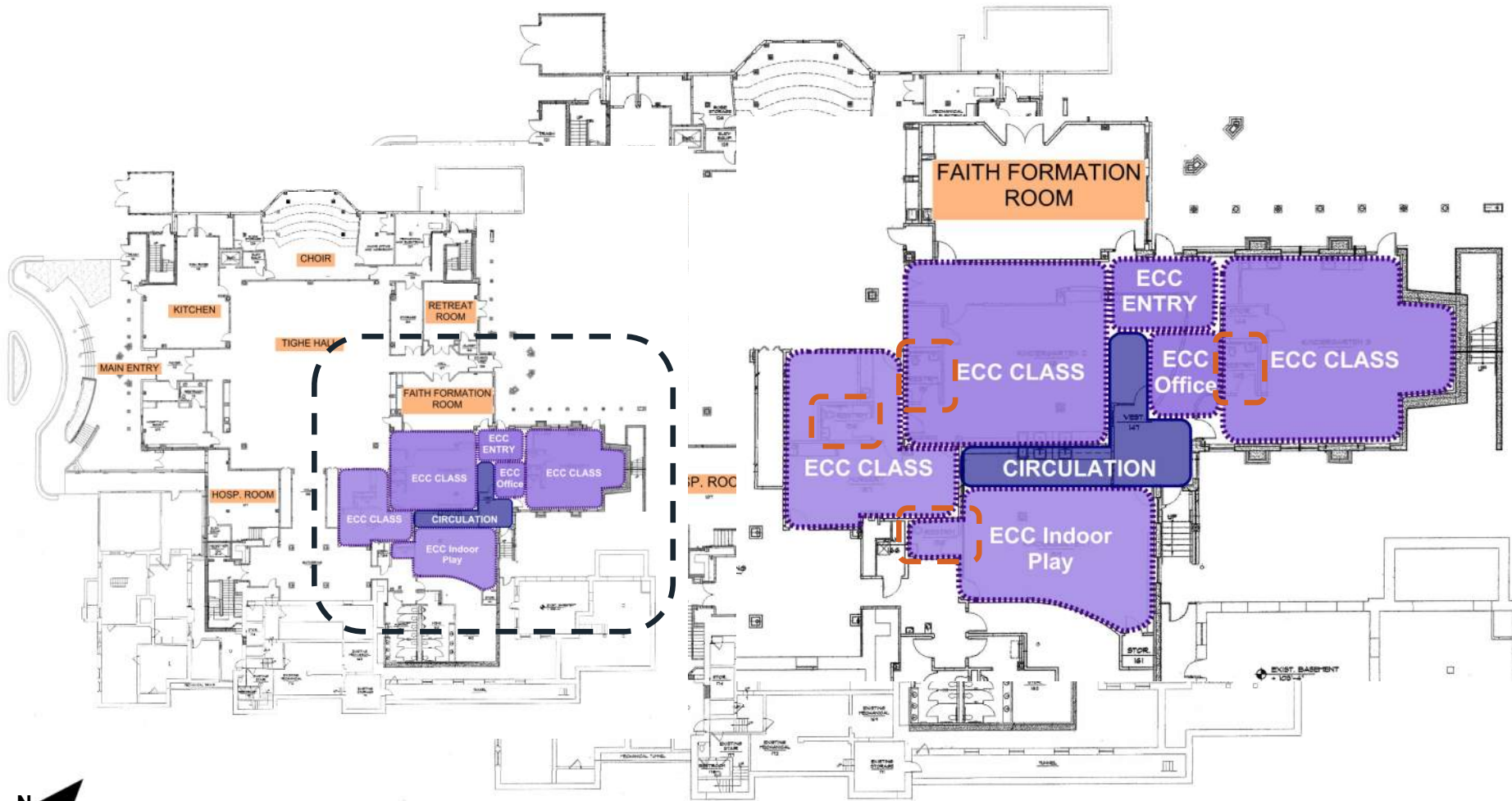

# Tighe Hall – ECC Option

 Existing restrooms to be renovated/re-used



# Remember.... We're Planning

- Rule 1:** Not all issues have to be solved right now!
- Rule 2:** Planning process will look at many options to address all needs.
- Rule 3:** Prioritization will become necessary as you look at needs and budgets.
- Rule 4:** Together as a community you will find the best option for your school & parish



Vision Exercise





**What will make  
this project a  
success...**

**For students?**

**For staff?**

**For your parish  
community?**



# Identifying the Needs

Mark your priority preference with a **green dot** on the scale

Note any comments on the campus areas with post-it



MOVE TO EXISTING SCHOOL BUILDING

KINDERGARTEN SHIFT

REMAIN IN BASEMENT OF CHURCH BUILDING



NEW PROGRAM

ECC PROGRAM

NO EARLY CHILDHOOD PROGRAM ADDED

NEW BUILDING ADDITION, WITH EXISTING BUILDING RENOVATIONS

BUILDING ADDITION

RENOVATION OF EXISTING SCHOOL BUILDING, WITH NO ADDITION



## BUILDING PRIORITIES

1 FUTURE ADDITION

2 FAITH COURTYARD

3 BALTIMORE AVE. ENGAGEMENT



4 MAIN ST. ENGAGEMENT

5 CAMPUS QUAD

6 PLAY AREAS

## SITE PRIORITIES

# Identifying the Needs

Mark images with **green dot** that illustrate expanded and/or new learning methods for Visitation that you believe benefit the school

- Courtyard & Outdoor Learning
- Maker Space & Project Lead the Way
- Collaboration
- Technology Expansion & Support

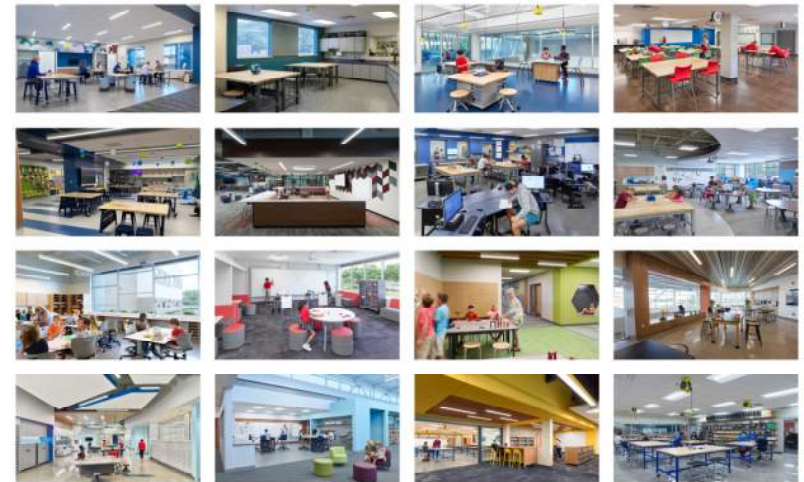

hollis<sub>4</sub> architecta miller we design the future! MAKER SPACE & PROJECT LEAD THE WAY



hollis<sub>4</sub> architecta miller we design the future! COURTYARD & OUTDOOR LEARNING



Note any comments on the campus areas with post-it



Mark images with **green dot** that illustrate expanded and/or new learning methods for Visitation that you believe benefit the school

Mark your priority preference with a **green dot** on the scale



# Group Share Out

---

## Open Comments & Leave Behind



### Visitation Catholic School

Master Plan  
May 24, 2022

We are excited to work together creating a long range master plan for Visitation Catholic Church as we look toward the future, and appreciate you being a valued member of our school & parish community. Your feedback is important to the vision of Visitation Catholic School and we encourage you to provide any additional feedback, comments or concerns below.

Thank you for your time and commitment!

---

---

---

---

---

---

---

---

---

---

---

---

---

---

---

---

---

---

---

---

---

---

---

---

---

---

---

---

---

---

# NEXT STEPS

---

- Reviewing options, feedback and adopting a plan

*Thank  
You!*